

OPTIONAL

UNSCREW BASE

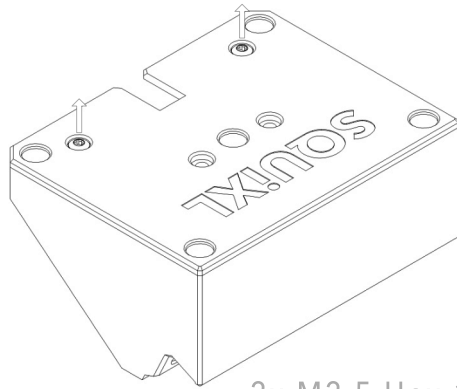

2x M2.5 Hex 1.5mm

INSERT NUTS FOR EXTRA WEIGHT

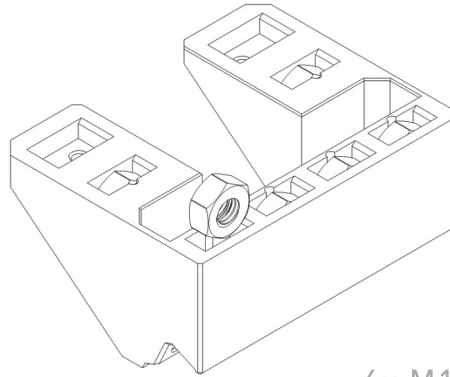

6x M10 Nuts

SCREW BASE BACK IN PLACE

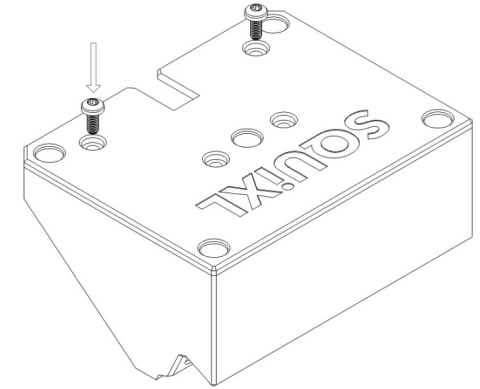

SLIDE BACK INTO FRONT

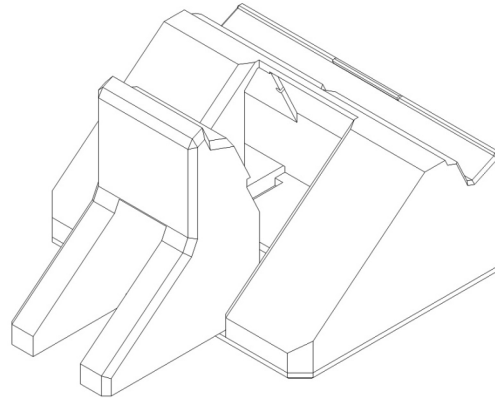

1

ENSURE IT'S IN ALL THE WAY

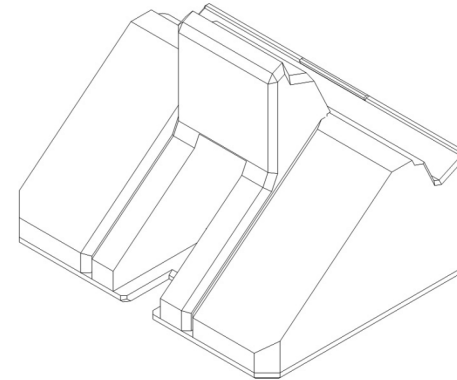

2

SCREW BACK INTO THE BASE

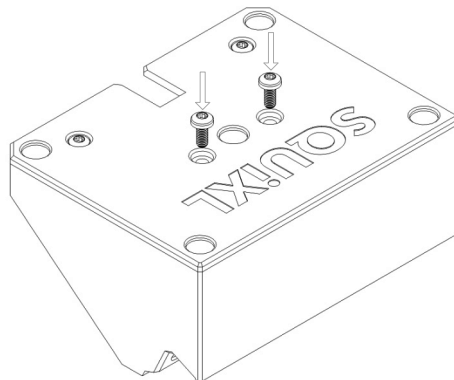

3

THAT'S IT, YOU'RE DONE!

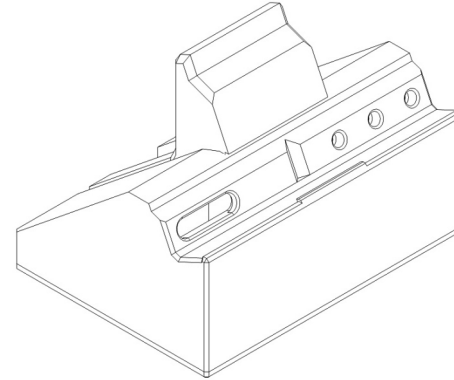

4

**SQUiXL**  
MAGNETIC DOCK  
ASSEMBLY GUIDE

